

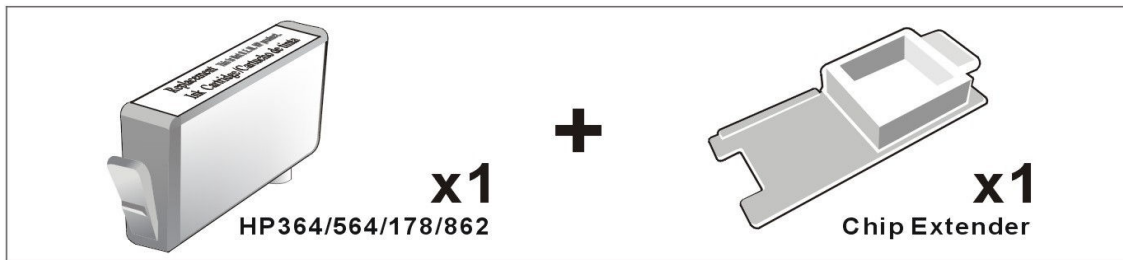

Installation Manual for compatible HP 364/564/178/862 ink cartridge with Chip Extender

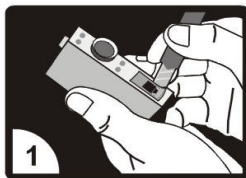

To use the chip extender:



Remove the chip from the used original inkjet cartridges carefully. Please do not damage the chip.

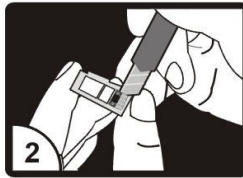

Put the original chip onto the chip extender in right direction.



Put the chip extender with chip in the corresponding cartridges carrier of printer. Please do not mix the colors.



Remove the label and orange cap from the new cartridge, and then put the cartridge into the cartridge carrier.

5) Replace the other inkjet cartridges in the same way.

To reset the chip:

- (1) When there is printer message of “Please replace the cartridges or Press OK to continue.” Please press “OK” to continue.
- (2) When there is printer message of “The original chips have run out or Press OK to continue.” Please press “OK” to continue.

Please kindly note:

After resetting the chip, its ink detecting function will be disabled. The actual ink level may be different from the displayed ink level.

Please pay attention to the actual ink volume during printing to avoid damaging the print head. Replace a new cartridge when you are experiencing broken line or light print.

If the chip extender has already been installed, need not to repeat step 1), 2) and 3).