

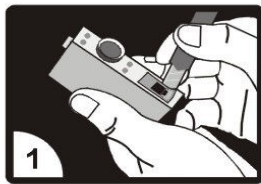

Installation Manual for *Canon® 525/526, 725/726, 225/226 replacement ink cartridges

To install the chip:



Remove the chip from the used original inkjet cartridges carefully. Please do not damage the chip.

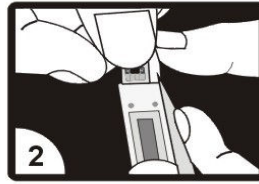

Stick the original chip onto the replacement inkjet cartridge in right direction.



Remove the label and orange cap from the new cartridge, and then put the cartridge into the cartridge carrier.

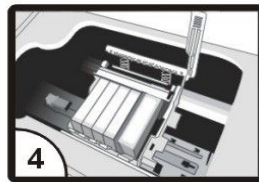

Put the replacement inkjet cartridge with chip in the corresponding cartridges carrier of printer. Please do not mix the colors.

5) Replace the other inkjet cartridges in the same way.

To reset the chip:

- (1) When there is printer message of “Please replace the cartridges or Press OK to continue.” Please press “OK” to continue.
- (2) When there is printer message of “The original chips have run out or Press OK to continue.” Please press “OK” to continue.

Please kindly note:

After resetting the chip, its ink detecting function will be disabled. The actual ink level may be different from the displayed ink level.

Please pay attention to the actual ink volume during printing to avoid damaging the print head.

Replace a new cartridge when you are experiencing broken line or light print.

*All brand names & trademarks are property of their respective owners.